

MHG SST (60Hz)

Height: 29.1" Width: 9.4" Depth: 18.6"
(73.9cm) (23.9cm) (47.2cm)



- BUNN BrewWISE wireless functionality assures error free operation: Intelligent Smart Hoppers communicate the type of coffee being used to the grinder
- The MHG references the specific grind time for the coffee batch to be brewed, and communicates the coffee name and selected batch size to the Smart Funnel during the grinding process
- The BUNN BrewWISE brewer reads the information in the Smart Funnel, adjusts the recipe, and brews a perfect batch of coffee
- LCD alphanumeric display shows coffee names, programming parameters and diagnostics
- USB port for easy programming
- Easy-to-use front-loading bean hoppers allow quick access for coffee change-outs, bean replenishment, and cleaning
- Compatible with both BUNN BrewWISE and non-BrewWISE brewers, as well as other makes of batch brewers of up to 1.5 gallons capacity
- Optional hopper storage racks display your selection of whole bean coffees to promote your fresh ground coffee program: an optional lock for lids (sold separately) prevents tampering in self-service applications
- Precision grinding burrs for consistent, quality grind
- PROP 65 Warning Decal included in packaging with equipment

Agency:



Specifications

Product #: 35600.0020

Interface: Wireless

Finish: Stainless

Hoppers: Two

Hopper Capacity: 6.00 lbs (2.722 kgs)

Additional Features

BrewWISE

Electrical & Capacity

Volts*	Amps	Watts	Cord Attached	Plug Type	8oz cups/hr 236ml cups/hr	Input H ₂ O Temp.	Phase	# Wires plus Ground	Hertz
120	11	1320	Yes	NEMA 5-15P	-	60°F (15.5°C)	1	2	60

*When a BUNN is machine rated 120/208-240V, 120/208V or 120/240V, the higher voltage is the supply voltage needed to power the machine. The 120V is there to supply power to some components rated 120V in the machine, but it is not the supply voltage and would not power the machine if the machine is marked with the before mentioned ratings.

Plumbing Requirements

PSI	kPa	Fitting Supplied	Water Flow Required (GPM)
-	-	-	-

CAD Drawings

2D	Revit	KLC
●		

WARNING: This product can expose you to chemicals including Bisphenol A (BPA), which is known to the State of California to cause birth defects or other reproductive harm. For more information go to www.P65Warnings.ca.gov



BUNN® reserves the right to change specifications and product design without notice. Such revisions do not entitle the buyer to corresponding changes, improvements, additions or replacements for previously purchased equipment. For most current specifications and other info visit bunn.com.

Last Updated:
03/20/2024

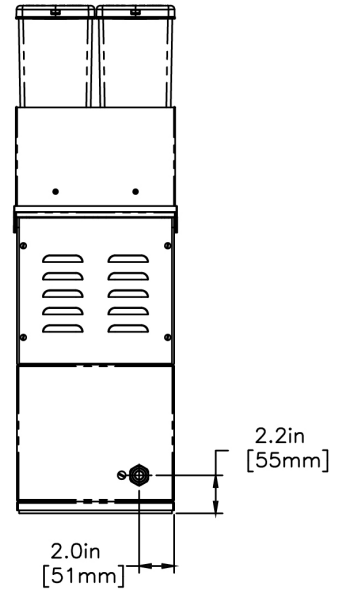
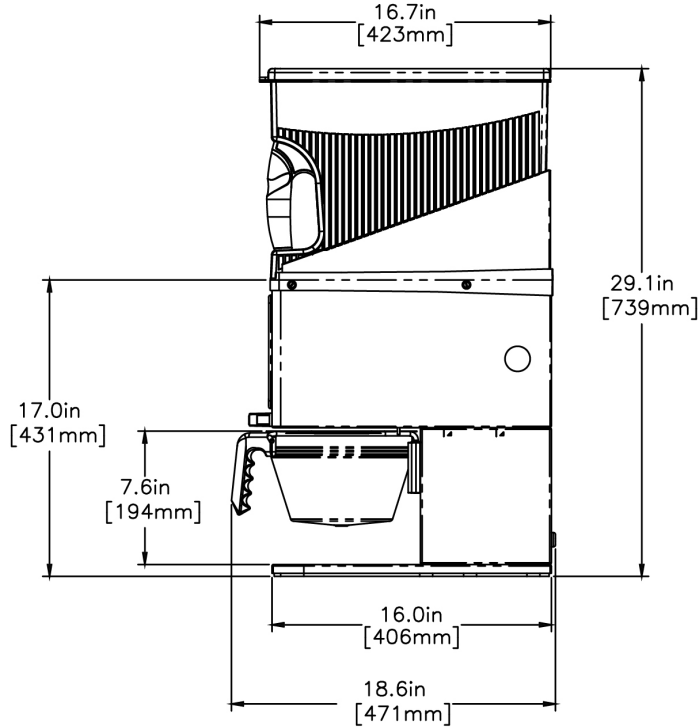
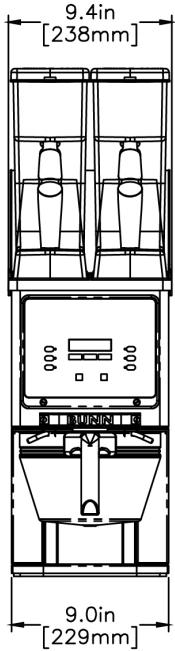
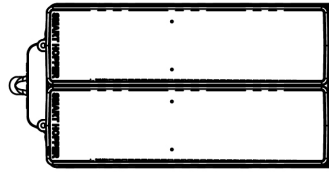

	Unit			Shipping				
	Height	Width	Depth	Height	Width	Depth	Weight	Volume
English	29.1 in.	9.4 in.	18.6 in.	36.5 in.	13.4 in.	23.8 in.	70.700 lbs	6.710 ft ³
Metric	73.9 cm	23.9 cm	47.2 cm	92.7 cm	34.0 cm	60.3 cm	32.070 kgs	0.190 m ³



BUNN® reserves the right to change specifications and product design without notice. Such revisions do not entitle the buyer to corresponding changes, improvements, additions or replacements for previously purchased equipment. For most current specifications and other info visit bunn.com.

Last Updated:
03/20/2024

Related Products & Accessories:MHG SST (60Hz)(35600.0020)

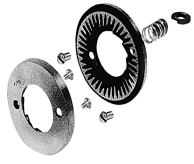

BURR SET KIT, NEW

Product #: 05861.1002

DECHAFFER PLATE,
SPRING STEEL

Product #: 05995.0000



BURR SET KIT, TURKISH
GRIND

Product #: 11285.1000

PADLOCK, Ø.156
SHACKLE

Product #: 29734.0000

CARD ASSY, RECIPE
TRANSFER (BRW)

Product #: 34447.0016

COVER, REMOVABLE
HOPPER ORANGE

Product #: 35771.0002



HOPPER RACK, MHG 2
POSITION

Product #: 36760.0000



HOPPER RACK, MHG 4
POSITION

Product #: 36760.0001



HOPPER/LID ASSY, MHG

Product #: 36845.0000



CLEANER, GRINDER
GRINDZ

Product #: 39159.0000

CLEANER,GRINDER
GRINDZ 12/CAS

Product #: 39159.0001



BUNN® reserves the right to change specifications and product design without notice. Such revisions do not entitle the buyer to corresponding changes, improvements, additions or replacements for previously purchased equipment. For most current specifications and other info visit bunn.com.

Last Updated:
03/20/2024

Serving & Holding Options: MHG SST (60Hz)(35600.0020)

Serving and Holding selections are currently unavailable. Please contact your sales representative to find out more information.



BUNN® reserves the right to change specifications and product design without notice. Such revisions do not entitle the buyer to corresponding changes, improvements, additions or replacements for previously purchased equipment. For most current specifications and other info visit bunn.com.

Last Updated:
03/20/2024